

HCTA Annual Membership Meeting
8/26/2023
10:00 AM at the 80th Street Firehouse

HCTA proudly encourages productive engagement with our taxpayers, on a year 'round basis. The Annual Membership Meeting was attended by more than 150 interested HCTA members. Constructive conversations were a welcome part of the before-, during-, and after-meeting interactions. Below are issues raised by taxpayers during the session's open Q&A and in sidebar Trustee conversations.

HCTA provided the questions to the Commissioners and asked that each of the three Commissioners divvy up these questions among their areas of impact and respond with their input. HCTA has combined related replies and conveys the responses below to the broader constituent base of HCTA which includes members and non-members.

Safety is a top concern among our taxpayers:

Boulevard Safety

Eblasts and signage regarding proper use of the recreational shoulder lanes

In Addition to HCTA's newsletters, the Borough uses various eblasts (town-wide email, and HCPD) to educate taxpayers regarding proper usage, along with appropriate use of the lighted Boulevard sign-board.

Communication about laws regarding cyclist use of the traveling lane

The NJ Division of Highway Traffic Safety is a key resource for education regarding bicycle safety, <https://www.njoaq.gov/about/divisions-and-offices/division-of-highway-traffic-safety-home/division-of-highway-traffic-safety-bicycle-safety/>. The Borough also uses eblasts (town-wide email, and HCPD) to educate regarding cyclists' use of the Long Beach Blvd. traveling lane, and the requirement to obey all vehicle traffic laws. HC will also make appropriate use of the lighted Boulevard sign-board for this purpose.

Clear rocks away from the recreational shoulder on Long Beach Bld. to improve walker/runner/cyclist safety.

While the County is responsible for the roadway, HC Public Works regularly clears the intersections. The Borough has agreed to speak with the County regarding better/more frequent cleaning of the recreational shoulder.

Look into marking the roadway with bike symbols as seen in Philadelphia and other larger towns.

Unfortunately, the HC section of Long Beach Blvd. does not have a bike lane appropriate [in width] for bike symbols; the Boulevard lighted sign-board will continue to be used for educational/safety messages.

Many requests have come in regarding more info regarding the **Streetscapes Project** including map coverage, detail images, etc. While there's no guarantee that the re-bid will come in within budget (though we're hopeful!), here are some elements from the re-bid package.

Overall Layout

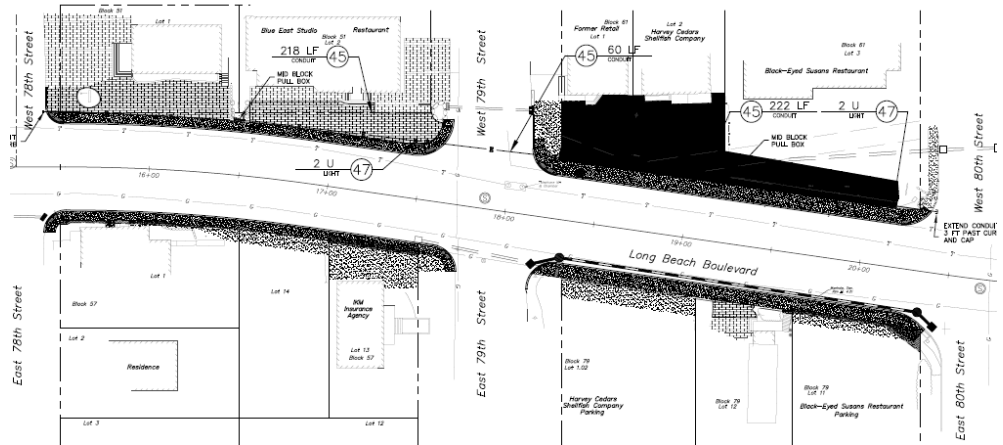

Concrete/Paver Sidewalk Detail

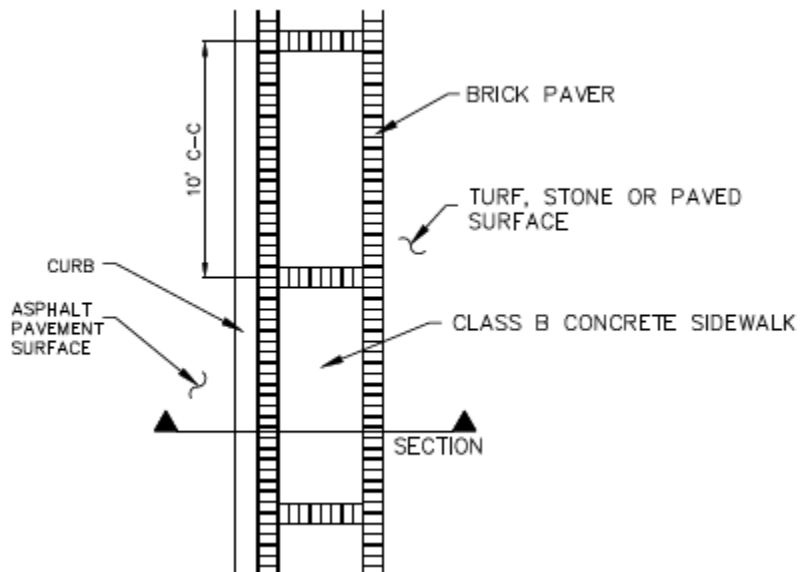

Bollard Design

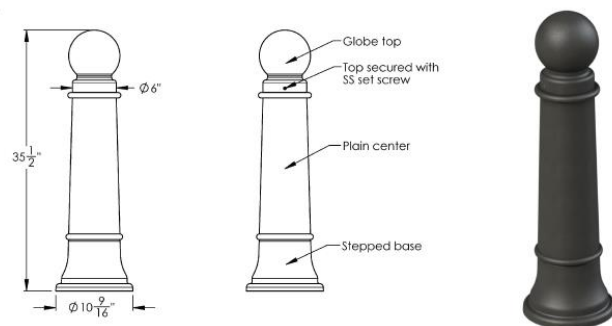

Beach Safety

When will replenishment begin in HC?

HC and the State will be issuing a notice to proceed scheduled for November 1, 2023. Mobilization will begin after that.

Is there a place or time for the public to swim outside the restrictions of lifeguard flags?

The Borough always recommends swimming near a lifeguard and between the flags. Residents may contact the Beach Patrol's Chief, Randy Townsend, for further information or to file a request for a special exception to the Borough's existing safety-focused lifeguard-swimmer protocols.

Neptune Market area safety issues

In the short-term, the Borough Commissioners will meet with the owners of the Neptune Market to discuss residents' concerns and explore a solution that includes delivery truck safety issues, parking and the position of dumpsters.

Cars backing out into recreational shoulder and Blvd is a clear safety hazard.

Neptune Market owners are working out a plan to modify layout and use of the Blvd side of the property for safer use of the storefront area; in the long-term safety will be enhanced by subsequent phases of the Streetscapes project.

81st Street signage indicating the one-way street needs to be clearer.

The Borough's safety officer(s) and the commissioner in charge of public safety plan to walk the area, fully understand the issue and evaluate it more closely. A solution will emerge from there.

Giglio Awnings uses their lot as unsightly outdoor inventory storage.

This falls under Code Enforcement and the issue has been raised before. This business is not in violation of any Borough ordinance, but the Borough's Police Chief and a Commissioner will meet with them so that they are fully aware of residents' concerns.

HCBC questions

Does HCBC pay taxes?

Yes, through the PILOT program (payment in lieu of taxes) and through normal taxation on two properties that are not used for religious programs.

The mayor's personal residence is not owned by the HCBC, it is privately owned by the Oldham family residing there and is subject to ordinary property taxes.

If HCBC makes a contribution in lieu of taxes, how much is it?

The HCBC 2023 contribution through the PILOT program is \$12,030.45. Taxes paid with other HCBC properties \$11,987.68 for a total of \$24,018.13.

Where does that money go in our municipal budget?

All money paid through the PILOT program goes directly to the Borough budget, not split out to the local or regional schools, or to the county.

HCBC pays for all its own trash pick-up as well as its full water/sewer responsibility.

Does the PILOT contribution include the 350 beach badges?

No, it does not. HCBC uses the preseason purchasing plan -- open to all -- to purchase 350 beach badges at the preseason rate.

Why were guests bussed to other beaches in summer 2023?

Erosion has caused many challenging issues for beachgoers in town, locals and owners as well as guests. In the 2023 season HCBC guests were transported to the beaches at Maris Stella, often referred to as "The Sisters," due to the badly eroded beach on their typical beaches, Middlesex and Atlantic (both accessed via the Mercer Ave beach entrance). The Sisters' beach was used by HCBC guests during the course of four weeks in the 2023 season, starting around July 10th for two weeks Mon-Thurs, and two weeks Mon-Fri. Never on the weekend. The fall 2023 beach replenishment project will rectify that issue. According to HCPD, there was no safety issue with respect to crossing the Blvd.

Why were residents of those locales not contacted about this happening?

While notice would have been an appropriate action in advance of the activity, there is no mandate to issue notice for normal beach use (meaning bathing, recreational use, etc.). Any person or group of people may purchase a beach badge(s) and use any beach, as they are all public beaches.

What behavior parameters are HCBC guests expected to abide by on campus and off campus?

All youth guests are required to wear a wristband indicating they are with the HCBC and must check in with their counselor at regular intervals. This is for not only behavioral oversight, but safety as well. NO cell phones, smoking or drinking is allowed on- or off-property; all guests must maintain a modest dress code. The youth must all attend 2 religious services per day as well as attend all scheduled meals and events. There are also quiet hours and a 10:30 PM curfew for youth program participants.

Nonprofit questions:

LBI Fishing Club, Barnegat Light Yacht Club and Maris Stella (same financial questions as for HCBC):

LBI Fishing Club is a 501(c)(7) organization and is not exempt from property tax liabilities, the Fishing Club pays property tax like any other property. In 2023, regular taxes, based on their assessment, are \$14,380.31.

Barnegat Light Yacht Club is also a 501(c)(7) organization and is taxed based on their assessment. In 2023, their total taxes due are \$13,719.73.

Maris Stella is a religious nonprofit, exempt on all their properties, they provide a contribution via the PILOT program. In 2023, the amount due is \$20,501.85.

Trolley repurposing?

Would it be possible to utilize the trolley one day a week in the off season for senior transportation? Perhaps a grant for this purpose?

The inquiry was directed at providing medical transportation services. On LBI, Interfaith Health & Support Services (IHSS, a non-profit) serves seniors. Twenty-three area congregations participate in providing services such as transportation to doctor appointments, library & community events, food shopping, making reassurance calls, and providing respite care for caregivers. Volunteer training is ongoing and volunteers are always needed and welcomed. Call

609-978-3839 to speak to Executive Director Amy Raimondi about how Interfaith can help you, or how you can volunteer to help Interfaith.

Locally, Dan Krupinski, Health Officer at the LBI Health Department will be the featured guest at the September 21st Community Forum (HC Borough Hall, 5 PM) and can answer questions about medical services on LBI.

Municipal well:

Why do we need another well?

The state of NJ is mandating HC to install a new well due to the fact we are exceeding our permitted number of gallons allowed to be pumped out of the ground. While we do not need an additional well, the state is mandating it. It should be noted that the current well, located at the Borough Hall, goes back to the 1960's.

Is all our water potable or are there different sources for watering & pools vs drinking?

All our water is potable, and the supply comes from our two existing wells: Salem Avenue by the water tower, and 76th street, located at the Borough Hall.

Who's paying for this new well?

The State of NJ, Harvey Cedars and Long Beach Township.

Who'll be responsible for testing the well once installed, how often?

Harvey Cedars will maintain the well, and if our old well ceases to be able to produce the necessary amount of water this new well will fill the gap.

Will our water/sewer rates change?

Sewer rates are based on water usage. Water rates will increase slightly, to cover the debt service on the well, in time.

Parking

What does enforcement look like in regard to the ordinance for 18' residential driveways?

The Borough of Harvey Cedars encourages residents to voluntarily declare the 18' driveway space for their property along the street front. This visual indication can be accomplished with landscape elements, hardscape (pavers, retaining walls) or a borough-painted driveway entrance (free of charge). The Borough Police and Public Works Department will work with residents interested in finding out more about marking driveways.

What happens if someone "parks in" a resident's?

It's important to give visitors (or anyone who parks on the roads in HC) the opportunity to make the right choice and not impede another person's right to use and enjoyment of their property. The risk faced when a residential driveway remains unmarked, by choice of the property owner, is that a vehicle may be discovered parked in a manner that blocks an unmarked driveway. If the property owner has chosen to not mark the driveway, it doesn't necessarily mean the identified vehicle is illegally parked. If anyone has a concern about an illegally parked vehicle, they should call the HCPD with the location.

Sunset Park concerns:

Playground condition

HC will be replacing the large middle piece of playground equipment this fall, 2023. It will cost around \$200,000. They received grant for \$100,000 which will cover 50% of the cost.

Geese

Goose poop can be a nuisance; geese don't have control over their poop, so they can leave a lot of it in places where we don't want it. HC will investigate the cost of "geese police." Our HC Public Work Dept welcomes additional ideas from our residents, please notify Public Works at 609-494-6905 to share your thoughts.

Trim trees

The trees by the tennis courts will be trimmed before the end of September 2023.

Taxes

Do Borough employees contribute to their benefits or is it all funded by HC?

Employees contribute a percentage based on their salary and the type of benefits elected. The scales are set by the state of NJ.

What are the parameters for new construction in HC?

BOROUGH OF HARVEY CEDARS Zoning Office

Wed. & Fri. 9:00 –11:00 a.m.

609-361-6000 option 8 ~ fax 609-361-6031

zoning@harveycedars.org

RA Zone, RAA Zone

Lot Size: 5000 SF 7500 SF

***Setbacks: Front 20 ft for structure/closed porch 25 ft for structure, decks & stairs
15 ft for open deck/porch***

Side 10 ft 10 ft

Rear 10 ft 15 ft

Water 15 ft 15 ft

Easements: see Ord. 13-7.4

Height:

Peaked roof: 32 ft structure with conforming setbacks

33 ft for properties West of LBB with 20" of fill

Peaked roof: 30 ft structure with existing non-conforming setbacks

Flat roof: 28 ft

Top of rail: 31 ft

Accessory: 15 ft

Fence: 4 ft residential, 6 ft commercial

Coverage:

Structure: 29%

Open decks: 4%

Total: 33%

Max coverage permitted with Pool: 43% (calculation to include required coping)

Max impervious coverage (pavers): 75%

Habitable: 50% of upland area with two (2) floors of habitable.

General:

Pools: Side-10', Rear-5', Water-10', Structure-8'

Hot tubs: Side-10', Water-4', Deck rails-2'

Accessory Structure: 5' from main structure

Trash Corral: 5' from edge of pavement

Landscaping: 5' from edge of pavement

Driveway: 18' wide/curb cut at edge of pavement

The HCTA wants our citizenry to understand that their concerns are being heard and responded to. The Commissioners' responses are appreciated and have been conveyed, as promised, to the complete HCTA database via email after the Labor Day holiday weekend.

Many thanks,

HCTA Board of Trustees